

SALES DRAWING SALES DRAWING SALES DRAWING

SALES DRAWING SALES DRAWING SALES DRAWING

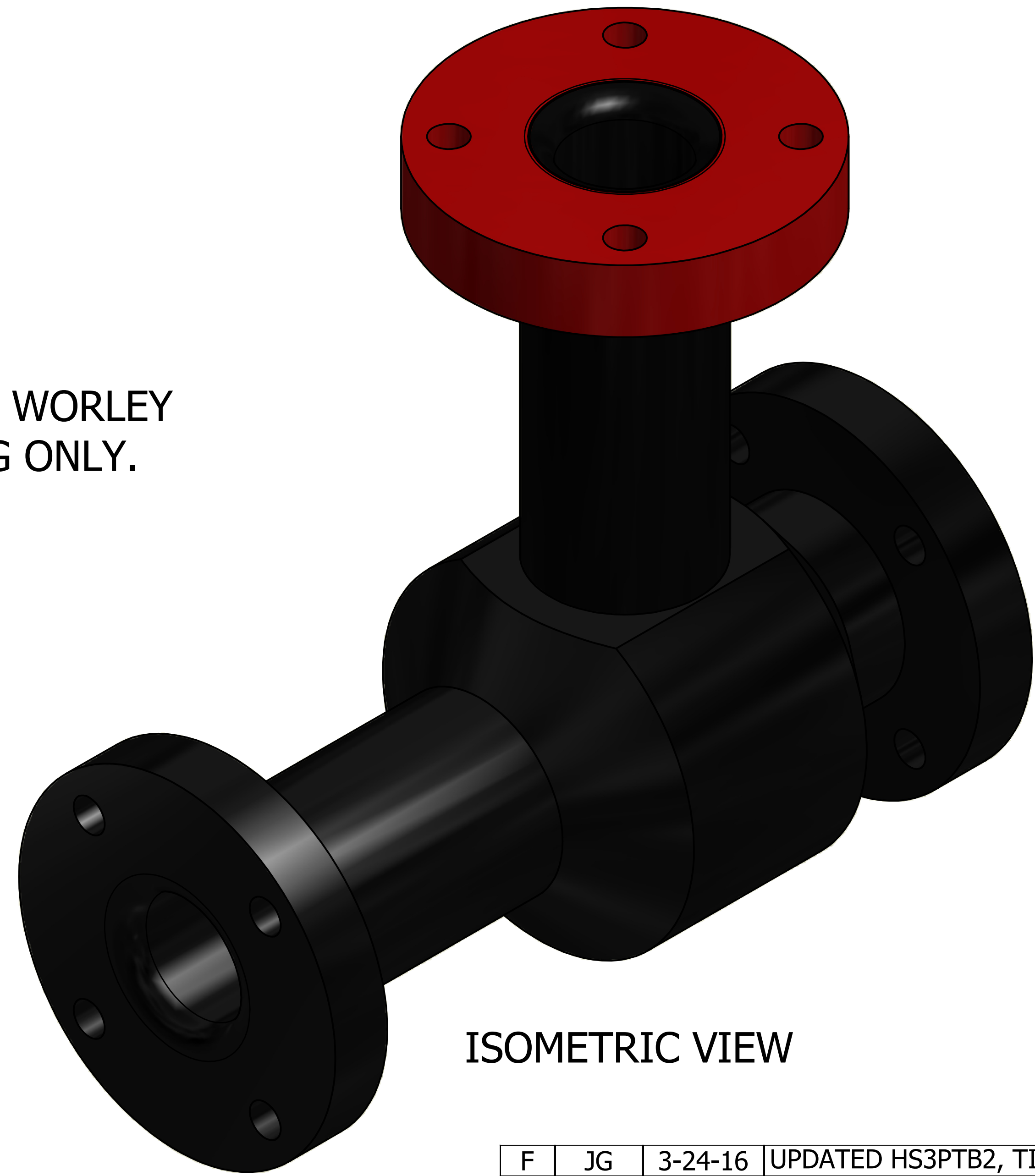

NOTE:
SOLD TO WORLEY
WELDING ONLY.

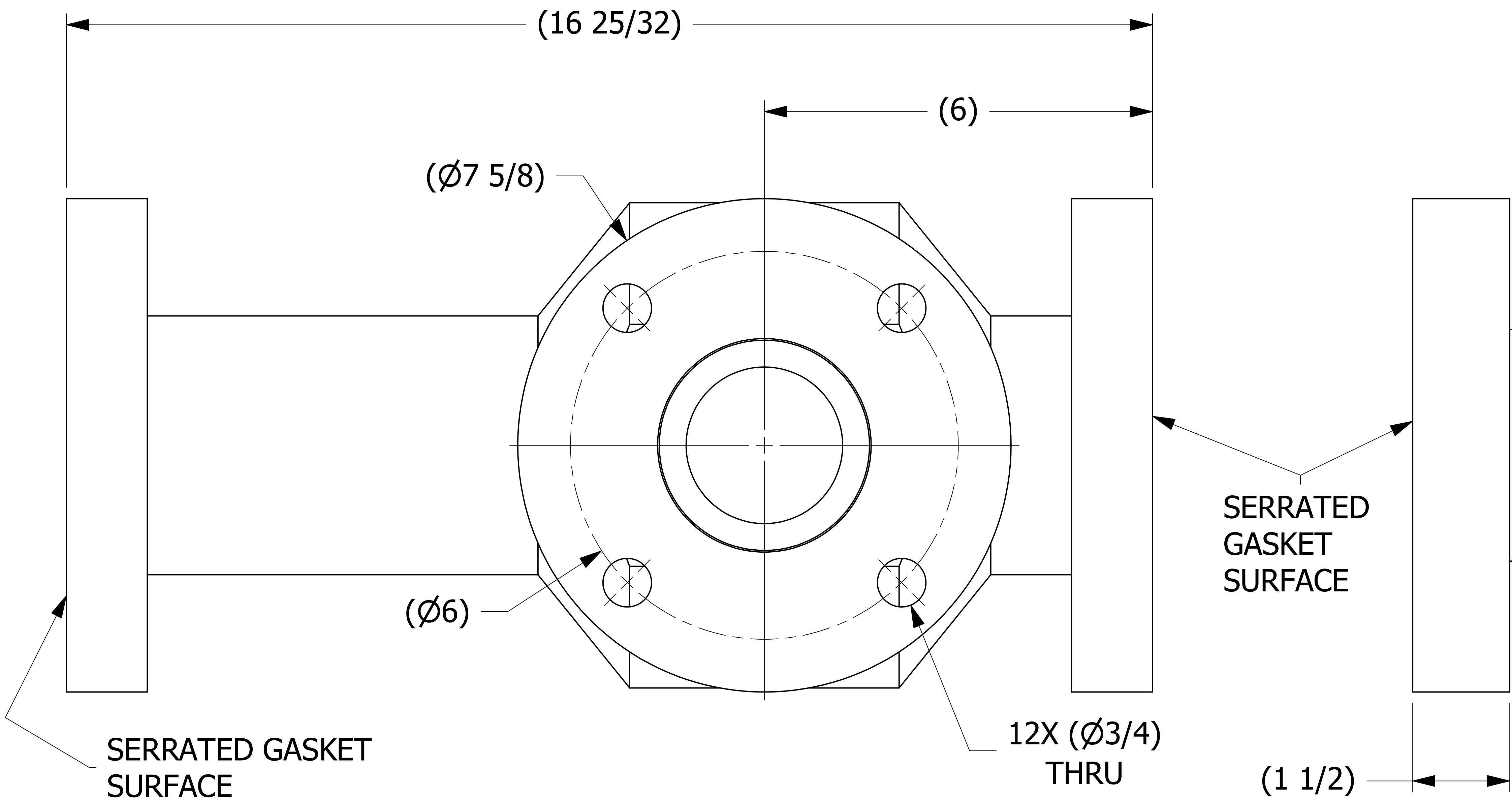
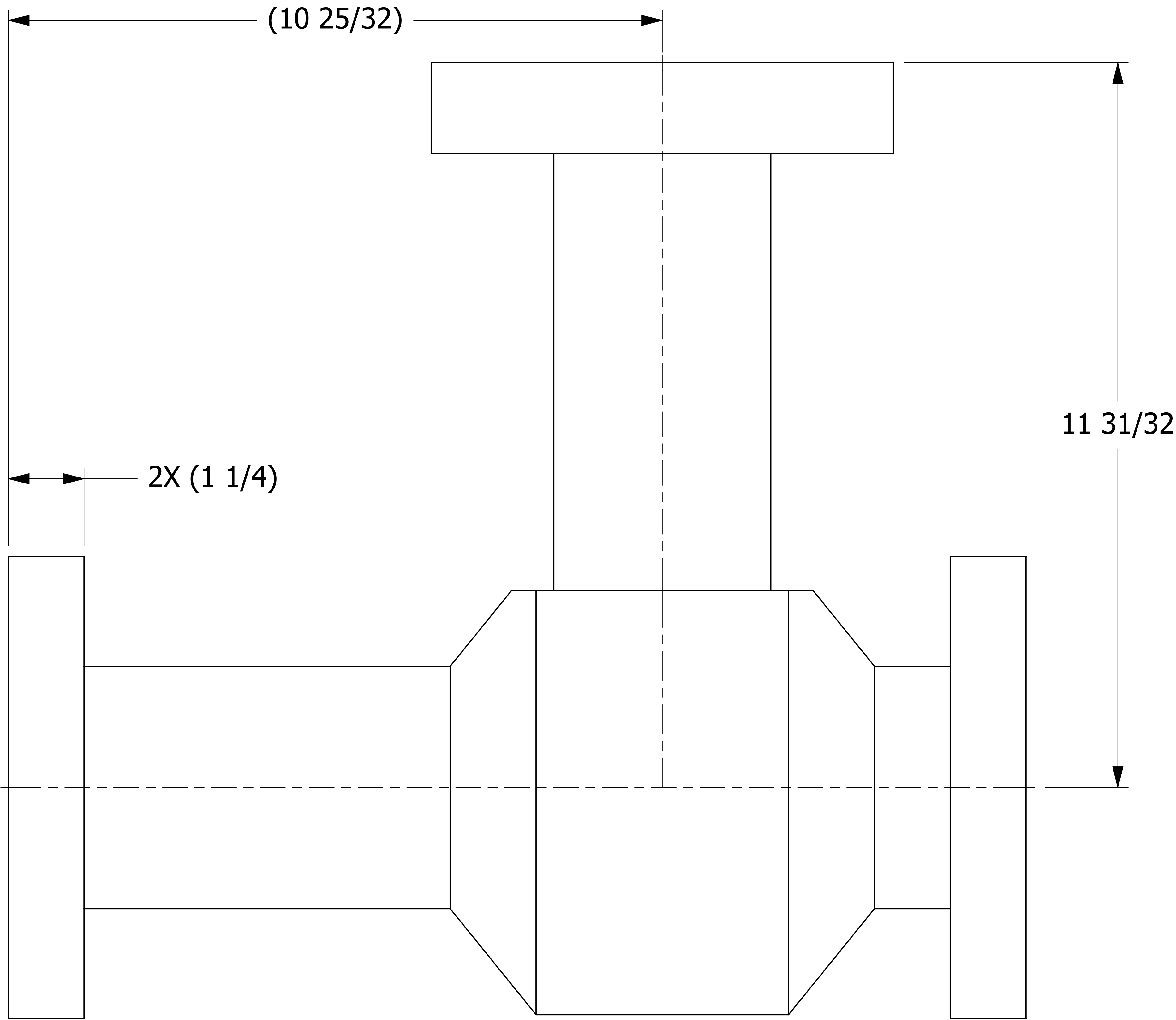

F	JG	3-24-16	UPDATED HS3PTB2, TITLEBLOCK, NOTES, DIMS
E	KHK	9-3-13	UPDATED TITLEBLOCK & CURRENT DRAFT STANDARDS ADDED FRICTION WELD NOTE, MARKING TEXT HEADER
D	GDS	7-28-11	ADDED MARKING PRESSURE NOTE
C	VD	8-12-10	REPLACED HS758FL W/ HS3FLGS, UPDATED NOTES
B	CHL	1-21-10	REPLACED HS3DTFL W/HS758FL
A	PJG	9-28-09	NEW PART ADDED TO SYSTEM
REV	BY	DATE	DESCRIPTION

UNLESS OTHERWISE SPECIFIED DIMENSIONAL TOLERANCES FRACTIONAL: $\pm 1/16$ X.XX: $\pm .03$ X.XXX: $\pm .015$ ANGULAR: $\pm 1^\circ$ DEBURR ALL SHARP EDGES. ALL MACHINED SURFACES TO HAVE A 125 RMS FINISH UNLESS NOTED OTHERWISE.	DRAWN BY: PJK	CHECKED BY: VD	PROTOTYPE BY: PJK	PROTOTYPE DATE: 5/22/2009	APPROVED FOR PRODUCTION BY: PJK	PRODUCTION DATE: 9/28/2009
THIRD ANGLE PROJECTION						

PART NAME: PIPE TEE 3"			
MATERIAL: SALCO PE			
PROJECT #: 090428	SHEET #: 1 OF 1	SCALE: 1:1	
DRAWING #: E26848	PART #: HS3PT3		